

MAKE YOUR MARK

2630 + 2680

SKY MARK

MISSISSAUGA

CROWN



2630 and 2680 Skymark Avenue is one of the most recognizable office complexes in the Airport Corporate Centre. Comprising two class 'A' towers, The 250,233 sq. ft. complex is LEED and BOMA Gold certified and has undergone a recent revitalization, which include lobby, washroom, elevators and elevator lobbies upgrades.

The complex offers amazing on-site amenities and conveniences such as a full service restaurant, fitness and conference centre. Its prime location provides fast and easy access to 400-series highways and public transit routes and is only 500 meters from the BRT.

With the advantageous combination of location, superior asset quality and space options, 2630 and 2680 Skymark will allow you to set your business apart and **make your mark.**



FIRST IMPRESSIONS MATTER

FULL-SCALE LOBBY RENOVATION COMING IN 2022!

INSPIRATION FROM 11 ALLSTATE PARKWAY, MARKHAM

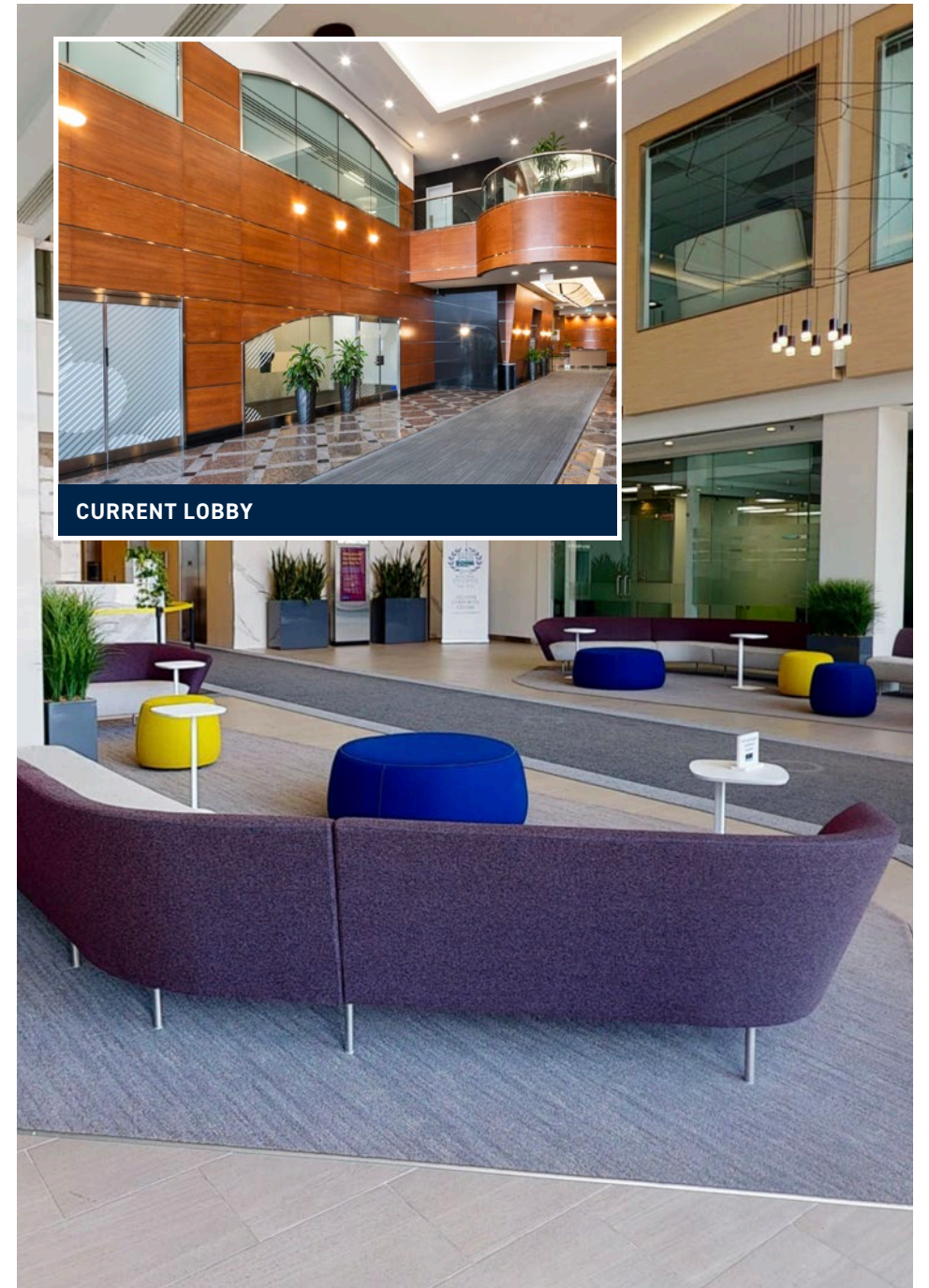

WORKPLACE. COMMUNITY.

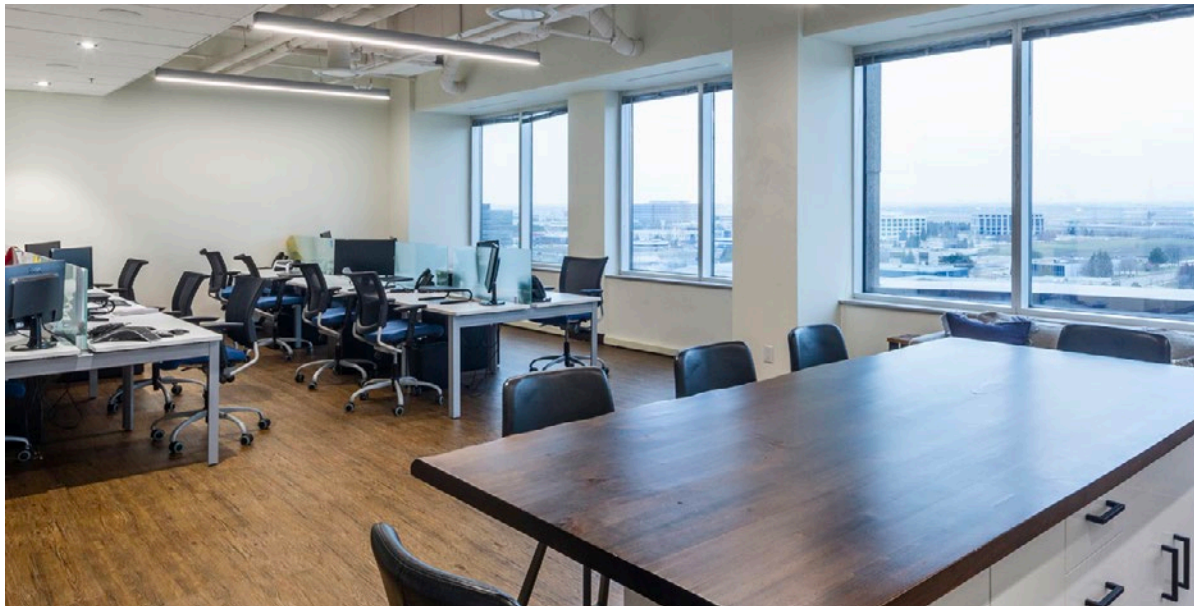

SUITE 902: 1,862 SQ. FT. OF MOVE-IN-READY SPACE

Join a tech focused workplace community at 2360 and 2680 Skymark with brands such as Dell, Fiserv, DCR Industries and Primus calling the complex home.

To enhance the 2630 and 2680 Skymark experience, Crown will be implementing a large-scale property repositioning which will include move-in ready model suites, collaborative areas among other upgrades!

CROWN READY MODEL SUITES UNDERWAY



PYLON SIGNAGE AVAILABLE

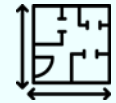

UP TO 31,000 SF
OF CONTIGUOUS
SPACE AVAILABLE



MOVE-IN READY
MODEL SUITES

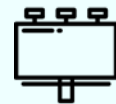

MAKE YOUR MARK WITH
PYLON SIGNAGE

EVERYTHING. HERE.

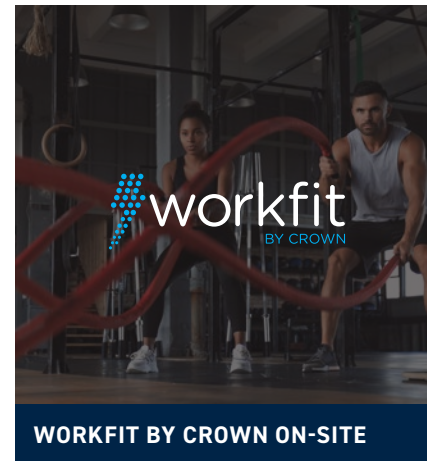

UNDERGROUND EXECUTIVE
PARKING WITH EV STATIONS
4/1000 SF



MINUTES FROM PEARSON
INTERNATIONAL AIRPORT



AMAZING ON-SITE &
AREA AMENITIES

AREA AMENITIES



Located in the Airport Corporate Centre - one of the most convenience locations in the GTA West node - 2630 and 2680 Skymark is moments from highways, transit lines and amazing amenities and conveniences, including restaurants, fitness centres, banks, hotels and parks. Only 10 minutes from Toronto's Pearson International Airport, 2630 and 2680 Skymark's location puts it in a convenient position for business travelers.

TRANSIT ROUTES

- 1 RENFORTH STATION**
MiWay: 7, 21, 24, 35, 35A, 39, 43, 87, 107, 109
TTC: 32A, 112B
GO Transit: Pearson Airport - Richmond Hill Square One/North York Finch Terminal
 - 2 ORBITOR STATION**
MiWay: 35, 35A, 87, 107, 109
 - 3 SPECTRUM STATION**
(MiWay - 35, 35A, 87, 107, 10)
-  **BRT 107/109, 35, 112** - every 8 minutes
23 minutes to Square One
15 minutes to Kipling Station
- ROUTE 7** - every 12 minutes
15 minutes to Pearson International Airport

ENDLESS OPPORTUNITY



FLEXIBLE SPACE



LARGE SCALE
REPOSITIONING
PLANNED



CROWN READY MODEL SUITES
COMING IN 2022

SAFE+SUITES

WORK SMART · WORK SAFE · WORK HEALTHY

[CLICK TO LEARN MORE!](#)



ROOM TO GROW

A GREENER WORKPLACE

2630 and 2680 Skymark provides a safe and healthy working environment for its tenants with the most sustainable and efficient office environment possible by utilizing industry leading best practices to increase the building's performance while reducing its environmental footprint.

SUSTAINABILITY CERTIFICATIONS & UPGRADES



LEED GOLD CERTIFIED

LEED certification is a globally recognized symbol of sustainability achievement and leadership. LEED is for all building types and all building phases including new construction, interior fit outs, operations and maintenance and core and shell.



BOMA BEST GOLD CERTIFIED

BOMA BEST® is a national green building certification program which evaluates standards for energy and environmental performance of existing buildings based on accurate, independently verified information.



WIREScore IN PROGRESS

WiredScore is the global digital connectivity certification system that helps Crown assess, improve and benchmark building connectedness. Our goal: making Internet and fibre connectivity easier for our tenants so they can work to their highest potential.



SUSTAINABILITY IN ACTION

Crown has an ongoing commitment to sustainable corporate and building operations. With environmental, social and governance (ESG) management and integral part of our strategy, our aim is to reduce our environmental footprint while elevating the way we operate for our clients, stakeholders and the greater community.

We manage and track what we believe to be the most important environmental indicators for our business: energy consumption, water usage, waste generation, and carbon emissions.



ENERGY USE
INTENSITY



WATER USE
INTENSITY



GHG
EMISSIONS



CAPTURE RATE FOR
NON-HAZARDOUS
WASTE

ABOUT CROWN

Founded in 2001, Crown Realty Partners acquires, leases, manages and redevelops commercial real estate assets across Canada. Crown has a well established track record, an experienced team and takes a hands-on approach to provide superior returns for our investors and better workplaces for businesses operating within our portfolio.

The Partners of Crown co-invest alongside the corporations, institutions, pension funds and high net worth individuals that entrust us with their capital, ensuring strong alignment of interests.

CROWN

For more information about the property or to arrange a tour, please contact:

Ryan McAskile*
Director, Leasing
647-727-4544
rmcaskile@crp-cpmi.com

crownrealtypartners.com | [@CrownCRP](https://twitter.com/CrownCRP)



MAKE

YOUR

MARK